

# armor

## 1100 SERIES DOOR CLOSER

### FEATURES

The 1100 series is hydraulic door closer. A hardened steel rack and pinion mechanism is housed in a aluminum alloy body. Suitable for left or right and opening doors, top jamb and standard installation

A parallel bracket is included for parallel arm installations. suitable for both metal and wood doors are included.

Dual valve adjustment screws

Closing speed is adjustable from 180 °~15 °by turning (Closing speed range) counter clockwise for faster, clockwise for slower.

The latching(Latching speed range) can be adjusted in the same way for the last 15 °of closing.

Optional Back Check; Hold Open arm.



### SELECTION CHART

SIZE No .	STANDARD / TOP JAMB INSTALLATION				DOOR WEIGHT (Ret) lbs
	Interior door width (mm)	Exterior door width(mm)		Minimum Lbf.	
		Swing out	Swing in		
1102	900	800	700	3	50~100
1103	950	900	800	5	80~150

SIZE No .	STANDARD / TOP JAMB INSTALLATION				DOOR WEIGHT (Ret) lbs
	Interior door width (mm)	Exterior door width(mm)		Minimum Lbf.	
		Swing out	Swing in		
1102	800	700	600	2	30~70
1103	900	800	700	3	50~100

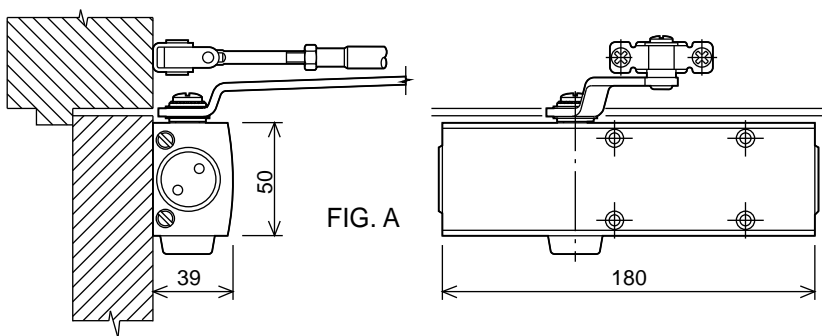

### ADJUSTMENT

- (1) Individual two speed adjusting valves for adjust both closing speed from 180 °~15 °and 15 °~0 °.
- (2) Speed adjusting valves turned clockwise for slow down the closing speed, turned counterclockwise for speed up the closing speed.
- (3) The Closing speed adjust range from 180 °to 15 °and latching speed adjust from 15 °to 0 °(refer to FIG. A).
- (4) Choose either of slide arm or cam hold-open arm (option), it may hold the door in any of your set-up point within 75 °to 180 °

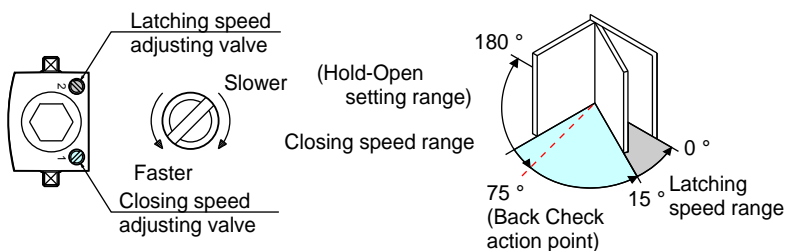

FIG. B



HENG KUO CO., LTD. – (TAIWAN)  
KUNSHAN HENG KUO MACHINERY CO., LTD

TAIWAN PLANT : No136, Ren De 5, Ta-Shi, Tao Yuan Hsien, Taiwan R.O.C.  
TEL : 886-3-380-2101 FAX : 886-3-380-2123  
CHINA PLANT : No.388 Lu Cnen Road kun Shan City CHINA  
TEL : 86-512-861-86625 FAX : 86-512-575-70392